



CHETO

CNC DEEP HOLE DRILLING WITH MILLING

www.cheto.eu

IXN Series 6 and 7 Axes

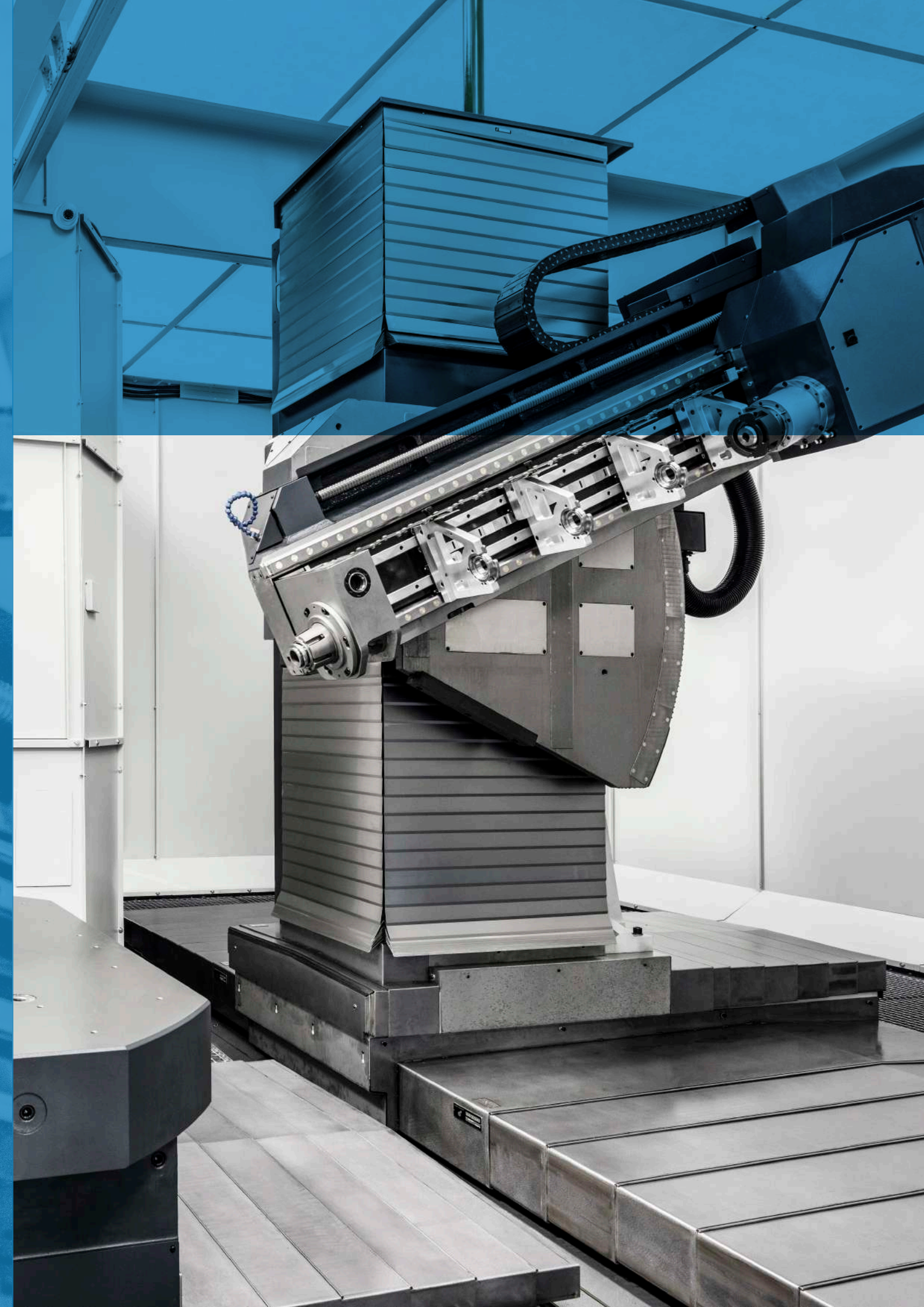

Location

CHETO TECHNOLOGICAL CENTER:

Área de Acolhimento Empresarial
UI-Loureiro, Lotes 13-21
3720-075 Loureiro, Oliveira de Azeméis
Portugal
GPS. 40°48'00.5"N | 8°30'35.3"W

CONTACT US

T. +351 256 247 970
E. info@cheto.eu



WORLDWIDE PRESENCE

■
INNOVATIVE CONCEPT
TO OPTIMIZE
DEEP HOLE DRILLING,
STANDARD DRILLING
AND MILLING
■



CHETO

CNC DEEP HOLE DRILLING WITH MILLING

INNOVATIVE machine tools

CHETO was officially established in 2009, when the founders started a project to fully develop a deep hole drilling and milling machine-tool up to 7-axes, specialized for the mold making and energy industry.

Since then, a continuous improvement and investigation allowed CHETO to offer the market a versatile product with high levels of accuracy and reliability.

This concept quickly positioned CHETO as a world-renowned brand. With machines sold in four continents, it is our goal to keep improving and innovating, to offer a highly competitive and value-creating product.



Management
System
ISO 9001:2015

www.tuv.com
ID 9105076158



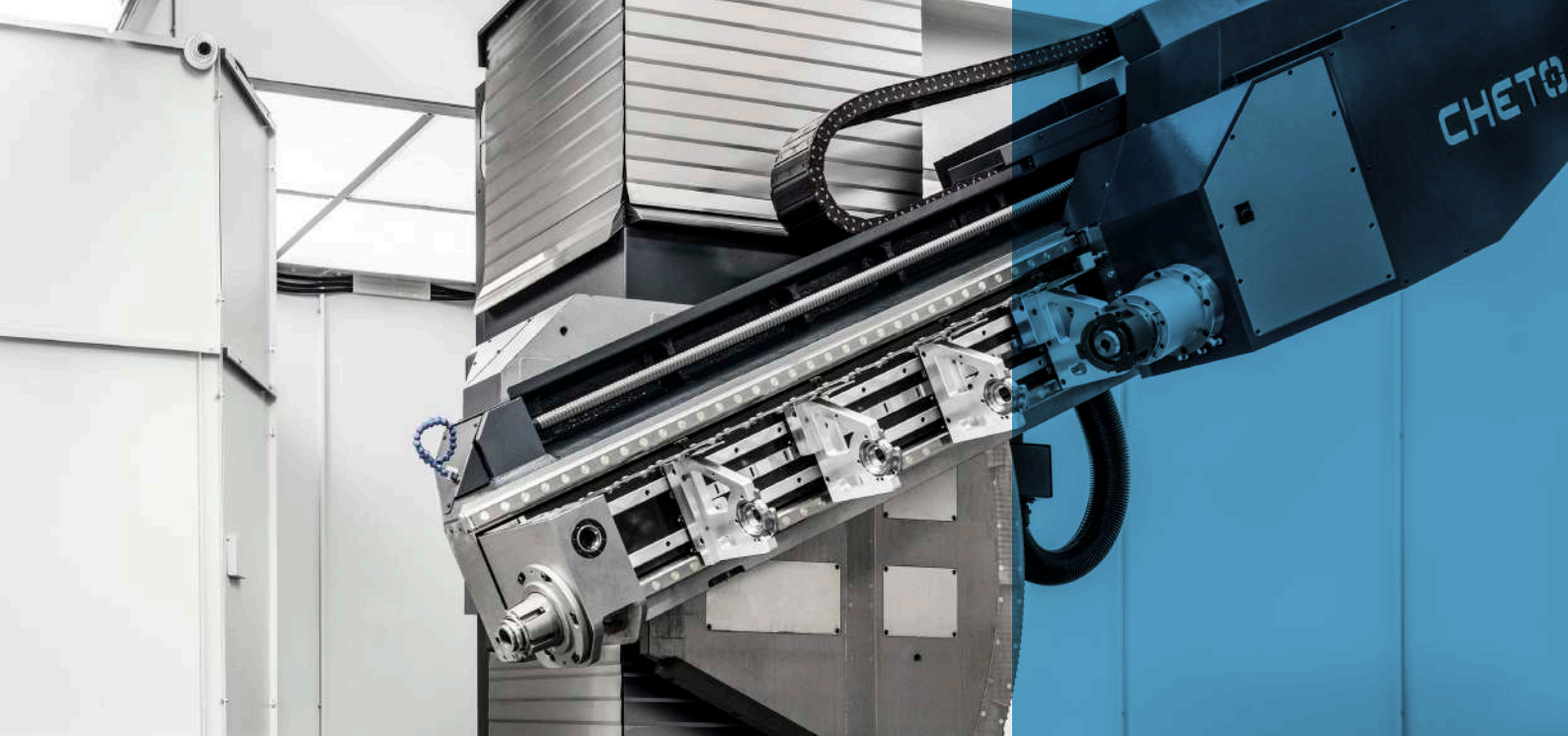

Technical Data

	1000		2000		3000	
CNC Axes						
W drilling one stroke	1630 mm	64.2 in	1630 mm	64.2 in	1630 mm	64.2 in
X longitudinal travel	1000 mm	39.4 in	2000 mm	78.7 in	3000 mm	118.1 in
Y vertical travel	1000 mm	39.4 in	1200 mm	47.2 in	1200 mm	47.2 in
Z cross travel	800 mm	31.5 in	800 mm	31.5 in	800 mm	31.5 in
B table rotation	360,000		360,000		360,000	
A tilting rotation	+25°/-15°		+25°/-15°		+25°/-15°	
Drilling capacity						
Max. drilling stroke W+Z	1630+800 mm	64.2+31.5 in	1630+800 mm	64.2+31.5 in	1630+800 mm	64.2+31.5 in
Drilling capacity	ø5-40 mm	ø0.2-1.58 in	ø5-40 mm	ø0.2-1.58 in	ø5-40 mm	ø0.2-1.58 in
Milling capacity						
Milling	300 cm³/min	18.3 in³/min	400 cm³/min	24.4 in³/min	500 cm³/min	30.5 in³/min
Rigid tapping	M30		M32		M34	
Helical threading	Standard		Standard		Standard	
Spindle						
Spindle taper	ISO 50 DIN 69871		ISO 50 DIN 69871		ISO 50 DIN 69871	
Speed	0-4500 rpm		0-4500 rpm		0-4500 rpm	
Power	11/15 kW	15/20 hp	15/22 kW	20/30 hp	22/33 kW	30/45 hp
Torque	140/200 Nm	103/148 ft-lbs	191/287 Nm	141/212 ft-lbs	280/420 Nm	207/310 ft-lbs
Automatic rotary table						
Table size	1300x1300 mm	51.2x51.2 in	1600x1300 mm	63.0x51.2 in	1800x1600 mm	70.9x63.0 in
Positioning type	360,000		360,000		360,000	
Max. load in rotation	10 Ton	22,047 lbs	20 Ton	44,093 lbs	30 Ton	66,139 lbs
Layout dimensions						
Total weight	25 Ton	55,116 lbs	28 Ton	61,730 lbs	34 Ton	74,958 lbs
Foot print (WxL)	7140x5760 mm	281.1x226.8 in	8690x6160 mm	342.1x242.5 in	9520x7410 mm	374.8x291.7 in

IXN 1000 | 2000 | 3000

— 6 AXES — 7 AXES

IXN 3000
Registered Design

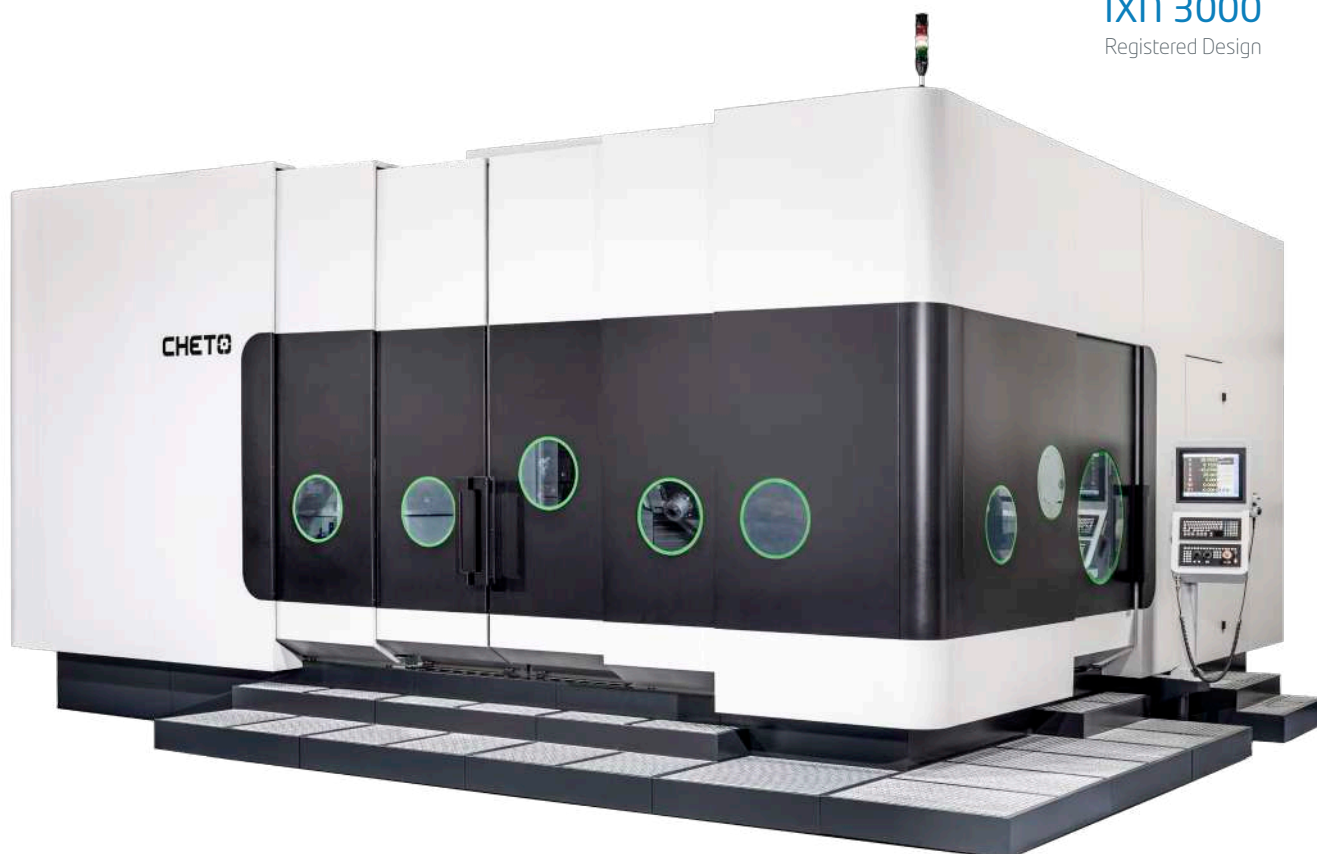

STANDARD EQUIPMENT

- CNC FAGOR 8065
- Option CNC HEIDENHAIN TNC 640
- Electronic handwheel
- Digital drives
- Nitrogen double counterweight
- Absolute linear encoders in axes X, Y and Z
- Absolute angular encoders in axes A and B
- Telescopic covers in all axes (except drilling axis)
- Kinematics / RTCP
- Rigid tapping
- Quick change between drilling/milling
- Coolant tank with automatic filtering
- Submerged pumps for oil recirculation
- High-pressure pump 80 bar, 100 l/min | 1,160 psi, 26.5 gal/min
- Automatic chip conveyor
- Complete cover with doors, laminated glass windows and acrylic ceiling

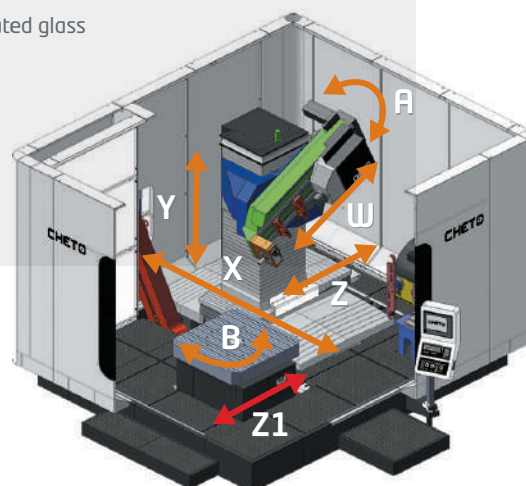



ADAPT MACHINING PARAMETERS ONLINE

- Spindle torque
- Feed
- Coolant pressure
- Coolant flow
- Vibration



TWO CONTROL
OPTIONS

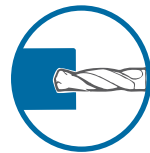

INTERSECTION

The system automatically detects intersections in the process and sets the parameters accordingly to keep the quality of the operation and to protect the tool lifetime.

PROCESS

The system detects variations of the efforts of the process and automatically adjust the drilling parameters online to keep a continuous process.



INTERFACE
REQUIREMENTS

HEIDENHAIN
TNC 640

FAGOR
CNC 8065

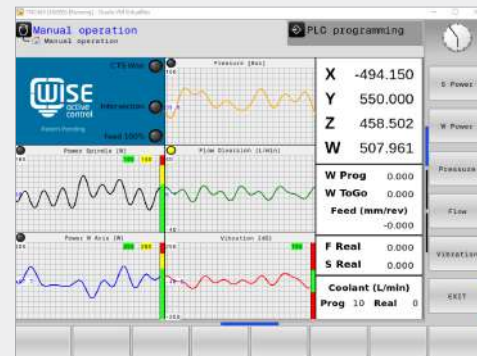

END OF
EXTRAORDINARY COSTS



END OF EXTRAORDINARY COSTS OF NONCONFORMANCE

The diversity of operations, the lack of raw materials homogeneity, the deficient parameter settings, and intersection holes often lead to the reduction of the tool lifetime. As hole intersections are a constant matter on mold making, and considering the difficulty of these operations, it's common to have problems on final results as unexpected hole drifts, premature tool wear or tool break.

Y AXIS = 1200 mm | 47.2 in
OPTION = 1500 mm | 59.0 in

W AXIS = 1630 mm | 62.4 in
OPTION = 2000 mm | 78.7 in

TABLE SIZE
ACCORDING TO CLIENT SPECIFICATIONS
MAX SIZE: 2000x2000 mm | 78.7x78.7 in

X AXIS

Z AXIS = 800 mm | 31.5 in

OPTION Z1 AXIS = 700 mm | 27.6 in

ATC GUNDRILL
UP TO 5 TOOLS



TILTING = +25°/-15°
OPTION = +25°/-25°

ATC 24 TOOLS
L = 300 mm | 11.8 in

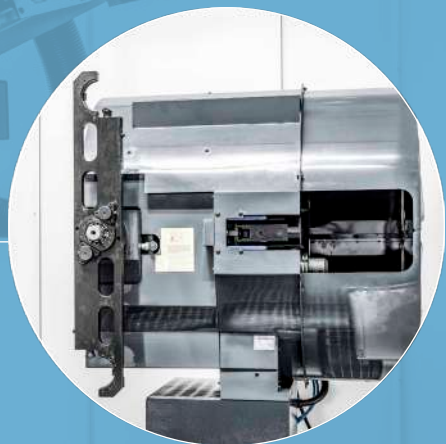

ATC 40/60 TOOLS
L = 300/600 mm
11.8/23.6 in



ATC UP TO 250 TOOLS
L = 600 mm | 23.6 in



IXN

STANDARD & OPTIONAL EQUIPMENTS

AIR CLEANING UNIT



CHETO

PAPER FILTRATION SYSTEM



IMMERSION CHILLER FOR OIL/EMULSION



FILTER UNIT
2000 / 3000 L
528 / 793 gal



HIGH-PRESSURE PUMP
80 bar 100 l/min | 1,160 psi, 26.5 gal/min
others upon request



COOLING UNIT
AC TO COOL THE ELECTRICAL CABINET

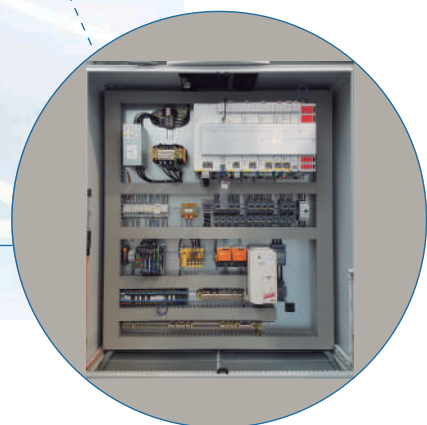

**EASY ACCESS TO THE
ELECTRICAL CABINET**



CHIP CONVEYOR

Registered Design

LASER MEASURING SYSTEM BLUM MCA7

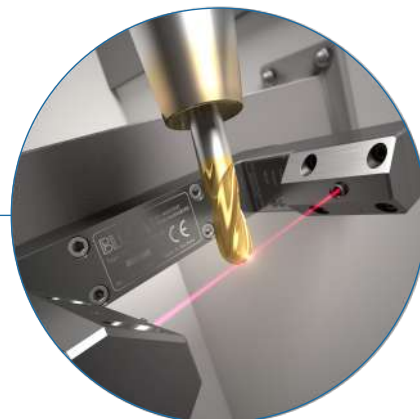

ELECTRIC PROBE BLUM TC60



TOOL CABINET



CHETO RE100 GUNDRILL GRINDER Ø5-32 mm | Ø0.2-1.26 in



OUR PRODUCTS & DESIGN



CC MODEL

1000

5 Axes

PWN MODEL

1000 / 2000 / 3000



IXN MODEL

1000 / 2000 / 3000

6 & 7 Axes

MT MODEL

1500 / 2500



SIC MODEL

6 Axes

- Efficient Deep Hole Drilling with Milling for Small Size Parts
- Working 5 Faces on a Single Setup
- 3+2 milling
- No Angle Limitation

**NEW
MODEL**



FOOT PRINT IXN MODELS

IXN1000

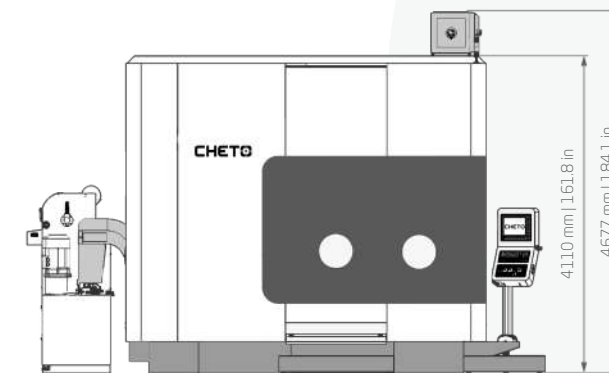

IXN2000

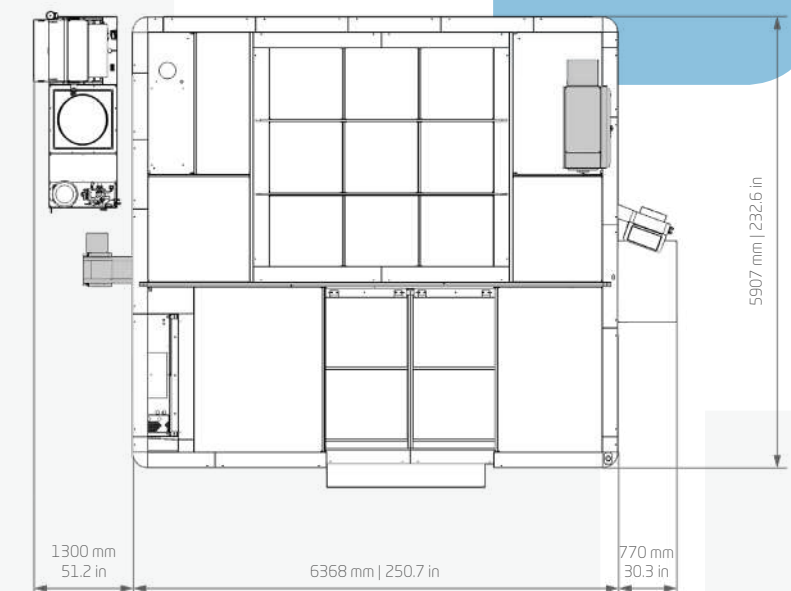
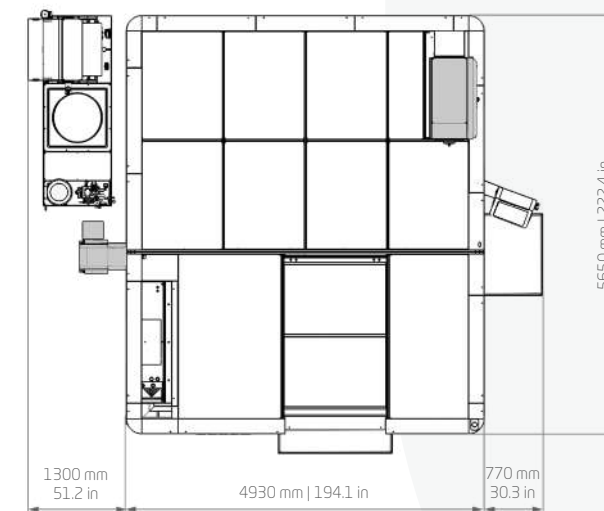
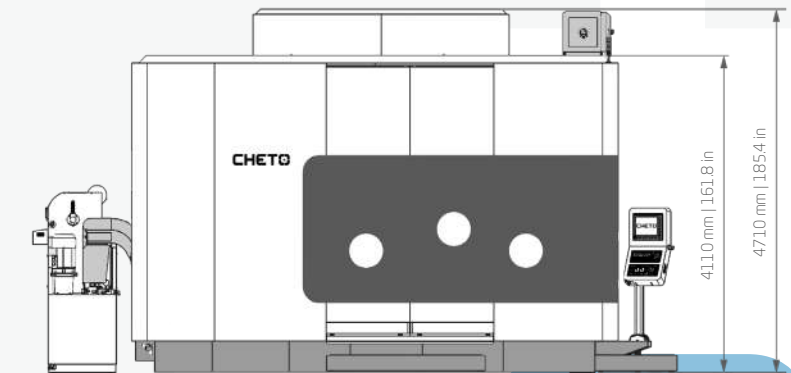

IXN3000

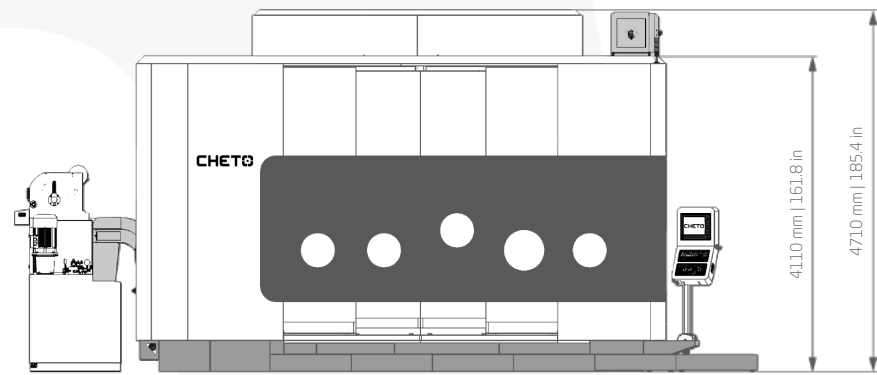

Registered Design

CHETOCORPORATION, S.A.

Área de Acolhimento Empresarial
Ul-Loureiro, Lotes 13-21
3720-070 Loureiro, Oliveira de Azeméis
Portugal

GPS: 40°48'00.5"N | 8°30'35.3"W
T. + 351 256 247 970

www.cheto.eu
info@cheto.eu

